

MOVE IT. CARRY IT. TOW IT. TAYLOR-DUNN IT.



1800 425 438



www.toyotamaterialhandling.com.au



BIGFOOT S

36 VOLT **AC** POWER

Ergonomic comfort & vehicle performance



Photos are shown with optional features.



Taylor-Dunn's BIGFOOT, with its game changing design, offers a large operator's compartment, tilted steering, and sliding adjustable seats, which increases legroom and reduces operator fatigue.

Additional standard features include our GT Drive system, AC power, Smart View Display, hydraulic disc brakes, recessed tie-downs, 12 gauge smooth skin, unitised steel body, DC/DC converter and a heavy duty all gear drive train that ensures reliability and low maintenance costs.

Features

- 36 AC powered
- 18 km/h speed
- 64-80 km range
- 907 kg load capacity*
- Large Operator's Compartment
- Tilted Steering
- Adjustable Seats



BIGFOOT S UTILITY VEHICLE

Performance

LOAD CAPACITY	907 kg
MAX SPEED (UNLOADED)	18 km / h
TURNING RADIUS	292 cm
TOW CAPACITY	2,268 kg

*Standard Configuration. Actual load capacity depends on application & vehicle configuration.

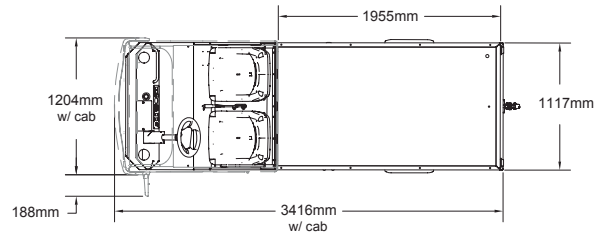

Dimensions

OVERALL LENGTH	301 cm
OVERALL WIDTH	112 cm
HEIGHT (with cab)	131 cm (185 cm)
WHEEL BASE	127 cm
GROUND CLEARANCE	11.4 cm
BED SIZE	165 x 112 cm

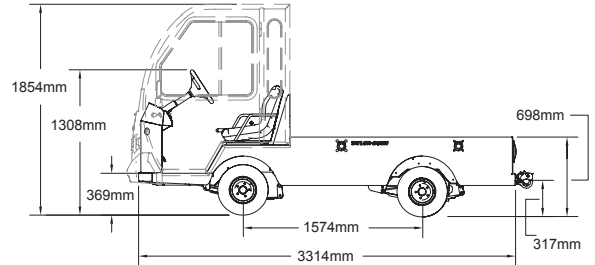

Power supply / Drive train

SYSTEM VOLTAGE	36 volt
MOTOR	6 hp, 4.5kW, AC
DRIVE AXLE	Direct-drive, automotive differential
BATTERIES	210 amp-hour, lead acid (FLA), 6 volt. Higher capacity options available: FLA (260 Ah) and AGM (224-250 Ah)
CHARGER	Built-in, 36 volt, 1 kW, 115 VAC/60 Hz with interlock
CONTROLLER	AC controller with dual, high-performance ARM cortex microprocessors

Chassis

FRAME	Fully welded, unitised, 12 gauge, smooth skin steel body
STEERING	Rack and pinion
SUSPENSION	Multi-leaf springs, front and rear
BRAKES	Rear hydraulic disc brakes with hand-operated parking brake
BUMPERS	Heavy duty steel integrated front & rear
TYRES	5.70 x 8, load range C, pneumatic

Options

- Steel cab with doors
- Strobe light pole
- Battery watering system
- Non-marking tires
- Pintle hitch
- Eco-cab
- Stake sides

General

UNIT WEIGHT	637 kg
SEATS	Black adjustable bucket seats, driver's seat electrical interlock, 2 person
INSTRUMENTATION	Horn, reverse buzzer, display (battery status, hours, fault code, speed), key switch, USB port, light switch, emer-selector, and DC/DC converter (on with key switch)
LIGHT ACCESSORIES	Dual LED headlights, taillights, reverse lights, and brake lights
CONFORMANCE	Type E OSHA 1910.178, ANSI B56.8



Dual USB Port



Adjustable Seats



Emergency Cut-off



Recessed Tie-downs



Large Compartment



LED Lighting



Tilted Steering

BIGFOOT 48 VOLT **AC** POWER

Ergonomic comfort & vehicle performance



Photos are shown with optional features.



Taylor-Dunn's BIGFOOT, with its game changing design, offers a large operator's compartment, tilted steering, and sliding adjustable seats, which increases legroom and reduces operator fatigue.

Additional standard features include our GT Drive system, AC power, Smart View Display, hydraulic disc brakes, recessed tie-downs, 12 gauge smooth skin, unitised steel body, DC/DC converter and a heavy duty all gear drive train that ensures reliability and low maintenance costs.

Features

- 36 & 48V AC powered
- 19 km/h speed
- 48-64 km range
- 1360 kg load capacity*
- Large Operator's Compartment
- Tilted Steering
- Adjustable Seats



BIGFOOT UTILITY VEHICLE

Performance

LOAD CAPACITY	1360 kg*
MAX SPEED (UNLOADED)	19 km / h
TURNING RADIUS	348 cm
TOW CAPACITY	3400 kg

*Standard Configuration. Actual load capacity depends on application & vehicle configuration.

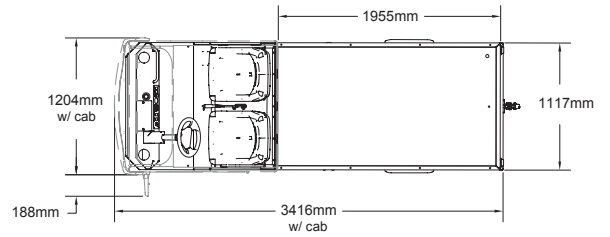

Dimensions

OVERALL LENGTH	332 cm
OVERALL WIDTH	112 cm
HEIGHT (with cab)	131 cm (185 cm)
WHEEL BASE	158 cm
GROUND CLEARANCE	14 cm
BED SIZE	112 x 196 cm

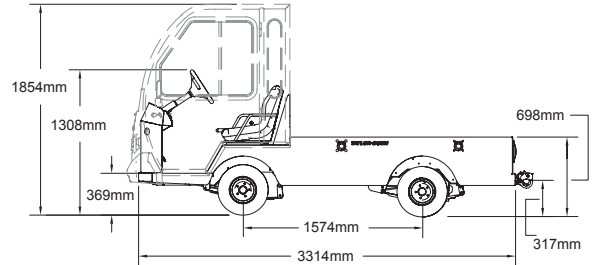

Power supply / Drive train

SYSTEM VOLTAGE	36 or 48 volt configuration
MOTOR	36V: 7.5 hp, 5.5 kW, AC, 48V: 12.5 hp, 9.5 kW AC
DRIVE AXLE	Helical gear, oil bath transaxle, GT automotive differential
BATTERIES	210 amp-hour, lead acid, 6 volt
CHARGER	Built-in, 115 VAC / 60 Hz, 1kW with interlock, 48V: 17 amp SCR
CONTROLLER	Solid state self diagnostic AC speed controller



GT Automotive Drive

Chassis

FRAME	Fully welded, unitised, 12 gauge, smooth skin steel body
STEERING	Rack and pinion
SUSPENSION	Multi-leaf springs, front and rear
BRAKES	Rear hydraulic disc brakes with hand-operated parking brake
BUMPERS	Heavy duty steel integrated front & rear
TYRES	5.70 x 8, load range C, pneumatic

General

UNIT WEIGHT	36V: 658 kg, 48V: 710 kg
SEATS	Black adjustable bucket seats, driver's seat electrical interlock, 2 person
INSTRUMENTATION	Smart View Display: (battery status indicator, hour meter, fault code display), reverse buzzer, F-N-R switch, key switch, light switch, high / low speed switch, emergency power cut-off switch, DC / DC converter, dual USB port, electric horn
LIGHT ACCESSORIES	Dual LED head lights, taillights and brake lights (Halogen head lights with deluxe cab)
CONFORMANCE	Type E OSHA 1910.178, ANSI B56.8

Options

- Fold-away seats
- Stake sides
- Ladder rack
- Portable charger
- Strobe light
- Diamond plate deck
- Aluminum drop-down sides
- Econo cab & vinyl doors
- Mid-range cab w/ steel doors
- Deluxe cab w/ steel doors
- Lockable cargo box
- Lift-out battery box
- Battery watering system
- Front disc brakes
- Various hitches
- Undercoating
- Galvanised frame
- Optional paint colours



Dual USB Port



Adjustable Seats



Emergency Cut-off



Recessed Tie-downs



Large Compartment



LED Lighting



Tilted Steering

BIGFOOT XL

48 VOLT **AC** POWER

Ergonomic comfort & vehicle performance



Photos are shown with optional features.



Taylor-Dunn is proud to announce an addition to its line of ergonomic BIGFOOT electric vehicles. The new BIGFOOT XL is a utility vehicle with a larger operator's compartment, hill climbing gusto, speed up to 29 km/h, and all-wheel hydraulic disc brakes.

Equipped with a 17 hp, 48 volt AC motor, GT drive, and rack and pinion steering, this electric utility vehicle will out-perform any other in its class.

Available customisations include deluxe cab, econo cab, fold-away seat, steel panel box, lockable cargo box, stake sides and aluminium drop-down sides.

Features

- 48 volt AC system
- 29 km/h speed, 54 km range
- 1361 kg load capacity
- Zero Emissions
- Exceptional Handling
- XL Operator's Compartment
- Tilted Steering
- Adjustable Seats



BIGFOOT XL UTILITY VEHICLE



Performance

LOAD CAPACITY	1361 kg*
MAX SPEED (UNLOADED)	29 km / h
TURNING RADIUS	368 cm
TOW CAPACITY	4536 kg

*Based on Standard Configuration: Actual towing capacity is dependent on application, vehicle configuration.

Dimensions

OVERALL LENGTH	332 cm
OVERALL WIDTH	145 cm
HEIGHT (with cab)	132 cm (188 cm)
WHEEL BASE	158 cm
GROUND CLEARANCE	14.7 cm
BED SIZE	137 x 196 cm

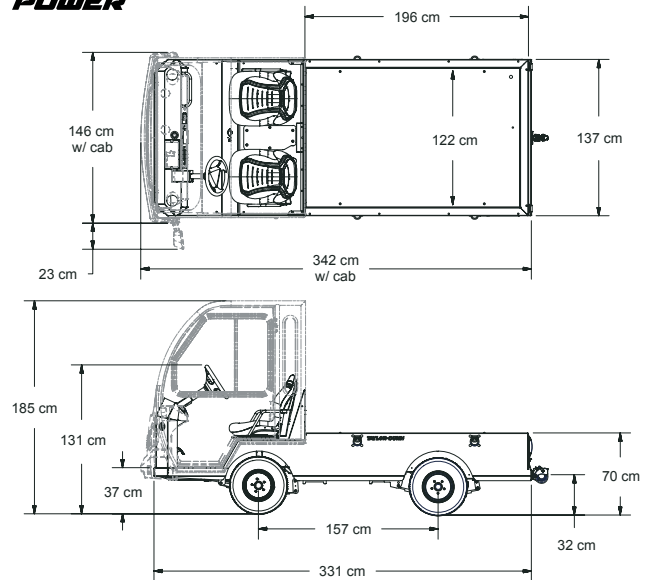

Power supply / Drive train

SYSTEM VOLTAGE	48 volt
MOTOR	17 hp, 13 kW AC
DRIVE AXLE	Helical gear, oil bath transaxle, GT automotive differential
BATTERIES	260 amp-hour, lead acid, 6 volt, 8 each
CHARGER	Built-in, 115 VAC / 60 Hz, 1kW with interlock, 48V: 17 amp SCR
CONTROLLER	Solid state self diagnostic AC speed controller



GT Automotive Drive

Chassis

FRAME	Fully welded, unitised, 12 gauge, smooth skin steel body
STEERING	Rack and pinion
SUSPENSION	Multi-leaf springs, front and rear
BRAKES	Front and rear hydraulic disc brakes, electric parking brake
BUMPERS	Heavy duty steel integrated front & rear
TYRES	20.5 x 8 x 10, load range E, pneumatic

Options

- Fold-away seats
- Stake sides
- Econo cab
- Portable charger
- Strobe light
- Vinyl doors
- Aluminum drop-down sides
- Deluxe cab w/ steel doors
- Diamond plate deck
- Lockable cargo box
- Lift out battery box
- Directional signals
- Steel panel box
- Battery watering system
- Various hitches
- Undercoating
- Galvanised frame
- Optional paint colours

General

UNIT WEIGHT	891 kg
SEATS	Black adjustable bucket seats, driver's seat electrical interlock, 2 person
INSTRUMENTATION	Clear view display (speed, distance, battery status indicator, hours, input diagnostic & fault code display), dual USB port, emergency power cut-off switch, light switch, forward / off / reverse selector, reverse alarm, high / low speed selector, key switch, DC / DC converter (on with key switch), and electric horn
LIGHT ACCESSORIES	Dual LED head lights, taillights and brake lights
CONFORMANCE	Type E OSHA 1910.178, ANSI B56.8



Dual USB Port



Adjustable Seats



Emergency Cut-off



Recessed Tie-downs



Large Compartment



LED Lighting



Tilted Steering



BIGFOOT_S



BIGFOOT



BIGFOOT_{XL}

POWER SUPPLY / DRIVE TRAIN			
Load capacity	2,000 lb (907 kg)	3,000 lbs (1,361 kg)	3,000 lbs (1,361 kg)
Tow capacity	5,000 lb (2,268 kg)	7,500 lbs (3,400 kg)	10,000 lbs (4,536 kg)
Turning radius	115 in (292 cm)	137 in (348 cm)	145 in (368 cm)
Max speed (unloaded)	11 mph (18 kmh)	12 mph (19 kmh)	18 mph (29 kmh)
Range	40-50 mi (64-80 kmh)	40-60 mi (48-100 kmh)	40-60 mi (64-100 kmh)
Charge time	8-10 hrs	10-13 hrs	10-13 hrs
Person capacity	2	2-4	2
DIMENSIONS			
Overall length	118.5 in (301cm)	130.5 in (332 cm)	130.5 in (332 cm)
Overall width	44 in (112 cm)	44 in (112 cm)	57 in (145 cm)
Height	51.5 in (131 cm)	51.5 in (131 cm)	52 in (132 cm)
Height with cab add-on	73 in with cab (185 cm)	73 in with cab (185 cm)	74 in with cab (188 cm)
Wheel base	50 in (127 cm)	62 in (158 cm)	62 in (158 cm)
Ground clearance	4.5 in (11.4 cm)	5.5 in (14 cm)	5.8 in (14.7 cm)
Bed size	65 x 44 in (165 x 112 cm)	77 x 44 in (196 x 112 cm)	77 x 54 in (196 x 137 cm)
POWER SUPPLY / DRIVE TRAIN			
Voltage	36 volt	48 volt	48 volt
Motor	6 hp, 4.5kW, AC	12.5 hp, 9.5 kW, AC	17 hp, 13 kW, AC
Drive axle	Direct-drive, automotive differential	Helical gear, oil bath transaxle, GT automotive differential	Helical gear, oil bath transaxle, GT automotive differential
Batteries	Standard: 210 amp-hour, flooded lead-acid (FLA), 6 volt Higher capacity options available: FLA (260 Ah) and AGM (224-250 Ah)	Standard: 210 amp-hour, flooded lead-acid (FLA), 6 volt Higher capacity options available: FLA (260 Ah), AGM (224-250 Ah), and Li-ion (6.1 kWh, 9.2 kWh, or 12.3 kWh)	Standard: 260 amp-hour, flooded lead-acid (FLA), 6 volt, 8 each Higher capacity options available: FLA (260 Ah), AGM (224-250 Ah), and Li-ion (6.1 kWh, 9.2 kWh, or 12.3 kWh)
Charger	Built-in, 36 volt, 1 kW, 115 VAC/60 Hz with interlock	Built-in, 48 volt, 1 kW, 115 VAC/60 Hz with interlock	Built-in, 48 volt, 115 VAC/60 Hz, 1kW with Interlock, 17 Amp SCR
Controller	AC controller with dual, high-performance ARM cortex microprocessors	Solid state self diagnostic AC speed controller	Solid state self diagnostic AC speed controller
CHASSIS			
Frame	Fully welded, unitized, 12 gauge, smooth skin steel body	Fully welded, unitized, 12 gauge, smooth skin steel body	Fully welded, unitized, 12 gauge, smooth skin steel body
Steering	Rack and pinion	Rack and pinion	Rack and pinion
Suspension	Multi-leaf springs, front and rear	Multi-leaf springs, front and rear	Multi-leaf springs, front and rear



BIGFOOT_S

BIGFOOT

BIGFOOT_{XL}

CHASSIS (continued)			
Brakes	Rear hydraulic drum brakes with hand-operated parking brake	Rear hydraulic disc brakes with hand-operated parking brake	Hydraulic disc brakes, front and rear, electric parking brake
Bumpers	Heavy duty steel integrated front & rear	Heavy duty steel integrated front & rear	Heavy duty steel integrated front and rear
Tires	5.70 x 8 in, load range C, pneumatic	5.70 x 8 in, load range C, pneumatic	20.5 x 8 x 10 in, load range E, pneumatic
GENERAL			
Unit weight	1,405 lbs (637 kg)	1,565 lbs (710 kg)	1,965 lbs (891 kg)
Seats	Black adjustable bucket seats, driver's seat electrical interlock, 2 person	Black adjustable bucket seats, driver's seat electrical interlock, 2 person	Black adjustable bucket seats, driver's seat electrical interlock, 2 person
Instrumentation	Horn, reverse buzzer, display (battery status, hours, fault code, speed), key switch, USB port, light switch, emergency power cut-off switch, high/low speed switch, forward/off/reverse selector, and DC/DC converter (on with key switch)	Horn, reverse buzzer, display (battery status, hours, fault code, speed), key switch, USB port, light switch, emergency power cut-off switch, high/low speed switch, forward/off/reverse selector, and DC/DC converter (on with key switch)	Horn, reverse buzzer, clear view display (speed, distance, battery status indicator, hours, input diagnostic & fault code display), dual USB port, light switch, emergency power cut-off switch, high/low speed switch, forward/off/reverse selector, key switch, DC/DC converter (on with key switch)
Light accessories	Dual LED headlights, taillights, reverse lights, and brake lights	Dual LED headlights, taillights, and brake lights	Dual LED headlights, taillights, and brake lights
Conformance	Type E OSHA 1910.178, ANSI B56.8	Type E OSHA 1910.178, ANSI B56.8	Type E OSHA 1910.178, ANSI B56.8
OPTIONS			
Optional accessories	Steel cab with doors, strobe light pole, battery watering system, non-marking tires, pintle hitch, eco-cab, stake sides	Li-ion batteries, fold-away seats, steel cab with doors, strobe light pole, battery watering system, non-marking tires, pintle hitch, eco-cab, second row seating, stake sides, aluminum drop sides, reverse lights, and more	Li-ion batteries, deluxe steel cab with doors, strobe light pole, battery watering system, non-marking tires, pintle hitch, eco-cab, stake sides, aluminum drop sides, reverse lights, and more

STOCKCHASER

The stock to dock product solution



Photos may be shown with optional equipment.



Taylor-Dunn's Stockchaser is a cost effective solution to improve efficiency in any warehousing application. This unique narrow aisle, highly maneuverable vehicle provides an ergonomic advantage by quickly bringing the operator closer to stock when order picking.

Features

- 24, 36 or 48 volt drive system
- 170 cm turning radius
- Zero emissions
- Regenerative braking (SC-100 only)
- 75 x 147 cm deck size
- Customisable to fit your application



STOCKCHASER

Performance

	SC-090	SC-100
LOAD CAPACITY	408 kg	454 kg
MAX SPEED	14 km / h	13 km / h
TOW CAPACITY	907 kg*	2268 kg*
TURNING RADIUS	170 cm	170 cm

*Based on Standard Configuration: Actual towing capacity is dependent on application, vehicle configuration, ballast weight, and operating environment.

Dimensions

OVERALL LENGTH	218 cm
OVERALL WIDTH	75 cm
HEIGHT	123 cm
WHEEL BASE	120 cm
DECK SIZE	75 x 147 cm
DECK HEIGHT	64 cm

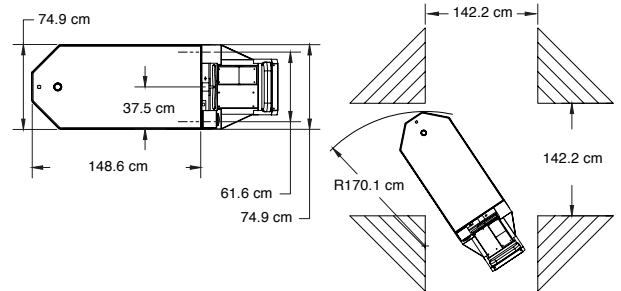
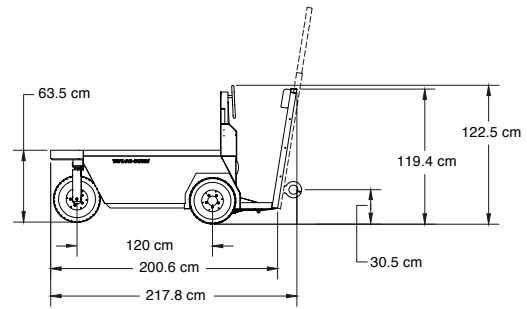

Power supply / Drive train

MOTOR	SC-090 (Series) -24: 3.8 hp, SC-100 (Separately Excited) -24: 4.3 hp, -36: 6.6 hp, -48: 8.8 hp
SYSTEM VOLTAGE	24, 36, and 48 Volt
TRANSMISSION	SC-090: Direct Gear Drive, SC-100: GT Automotive Type Differential
BATTERIES	210 Amp-hour, 6 Volt, Lead Acid
CHARGER	SC-090-24 & SC-100-24: Built-in, 600 Watt, 110 VAC Automatic w/ Interlock SC-100-36: Built-in, 1kW, w/ Interlock, SC-100-48: Built-in, 1kW, 60 Hz, w/ Interlock, 110 VAC
CONTROLLER	Solid State Speed Controller, Regenerative Braking

Chassis

FRAME	Fully Welded, Unitised, 16 Gauge, Diamond Plate Steel Body
STEERING	Manual, Chain Linkage, Front Fork, Clover Leaf Steering Wheel
SUSPENSION	Solid Mounted Rear Axle
BRAKES	Hand-Operated Parking Brake SC-090: Rear Drum, SC-100: Rear Disc
TYRES	4.80 x 8 Load Range B Pneumatic



GT Automotive Drive (SC-100 only)

General

UNIT WEIGHT	SC-090: 760 (345) SC-100-24: 970 (440) SC-100-36: 1095 (497) SC-100-48: 1195 (542)
OPERATOR COMFORT	Padded Backrest
INSTRUMENTATION	SC-090: Battery Status Indicator, F-N-R Switch, Key Switch, Electric Horn SC-100: Smart View Display, F-N-R Switch, Reverse Alarm, DC/DC Converter, Electric Horn
CONFORMANCE	Type E OSHA 1910.178, ANSI B56.8

Options

- Strobe light
- Head light / taillight
- Round steering wheel
- Knee pad, comfort kit
- Hour meter (sc-90 only)
- 4, 5 or 6 step ladder
- Diamond plate deck
- Portable charger
- Strobe light on a pole
- Soft solid tyres
- Solid cushion tyres
- Dual front fork
- Wider deck
- Clipboard holder
- Second level deck
- Lift-out battery box
- Roll-out battery box
- 225, 260 Amp-hour battery
- Various hitches
- Smooth skin frame
- Tie downs

MULE C-432

Heavy duty narrow towing solutions



Photos are shown with optional features.



Our three-wheel design allows the C-432 to provide the shortest turning radius available in a sit-down combination burden carrier / tow tractor. With its 71 cm wheelbase, this vehicle can maneuver into corners other powered vehicles simply cannot reach.

Equipped with heavy-duty batteries and a built-in fully-automatic charger, this vehicle is always ready to go. It's ideal for moving loads over smooth floors in warehouses, hospitals, schools, and hotels where quiet, fume-free operation is necessary.

Customisations include strobe light, reverse alarm, portable charger, head lights, taillights, fibreglass cab, vinyl doors, side / rear view mirrors, hitch, and soft solid tyres.

Features

- Built-in fully automatic charger
- Easily clears narrow aisles and doorways
- Fully-welded all steel construction
- Adjustable seat
- 75 x 117 cm deck (-cab)
- Customisable to fit your application



MULE C-432 TOW TRACTOR

Performance

LOAD CAPACITY	635 kg
TOW CAPACITY	3969 kg*
DRAWBAR PULL	780 kN
MAX SPEED (UNLOADED)	14 km / h
TURNING RADIUS	178 cm

*Based on Standard Configuration Actual towing capacity is dependent on application, vehicle configuration, ballast weight, operating environment, and vehicle maintenance.

Dimensions

OVERALL LENGTH	201 cm
OVERALL WIDTH	76 cm
HEIGHT (with cab)	102 cm (164 cm)
DECK HEIGHT	58 cm
WHEEL BASE	71 cm
DECK SIZE (with cab)	75 x 117 cm (75 x 102 cm)

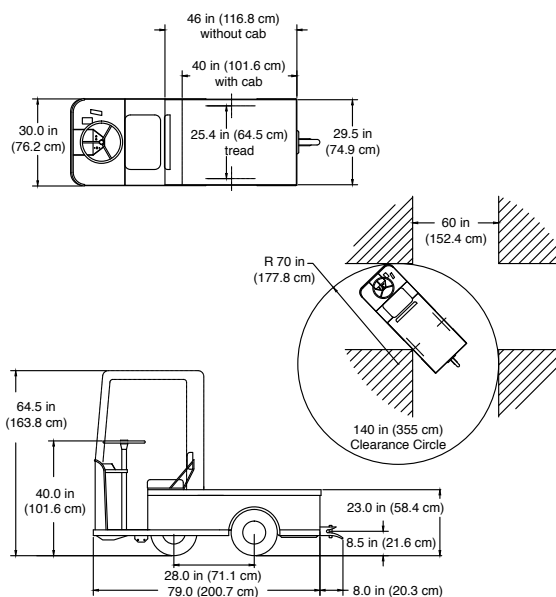

Power supply / Drive train

MOTOR	36V, 4.5 kW, DC, 6 Hp
SYSTEM VOLTAGE	36V DC
DRIVE AXLE	Power Traction Automotive Differential
BATTERIES	210 Amp-hour Lead Acid, 6 Volt, 6 Each
CHARGER	Built-in Automatic, 1 kW, 36 Volt, 110 VAC w/ Interlock
CONTROLLER	400 Amp, 36 Volt, Solid State

Chassis

FRAME	Fully Welded, Unitised, 16 Gauge, Diamond Plate Steel Body
STEERING	Manual, Chain and Sprocket Reduction to Front Fork
SUSPENSION	Solid, Front and Rear
BRAKES	Mechanical Rear Drum Brakes, Hand-Operated Parking Brake
TYRES	4.80 x 8, Load Range B, Pneumatic

General

MAXIMUM OCCUPANCY	1 (113 kg)
UNIT WEIGHT	416 kg
SEATS	Single, Adjustable, Black Vinyl, w/ Safety Seat Switch
INSTRUMENTATION	Battery Status Indicator, Forward / Reverse Selector, Key Switch, Electric Horn
CONFORMANCE	Type E OSHA 1910.178, ANSI B56.8 and B56.9

Options

- Head light / Taillight
- Portable charger
- Reverse lights
- Hour meter
- Non-marking tyres
- Windshield wiper
- Reverse alarm
- Beacon or strobe light
- Fibreglass cab
- Directional signals
- Stake sides
- Diamond plate deck
- Soft solid tyres
- Side / rear view mirrors
- Vinyl doors
- Various hitches
- Custom paint colour
- Undercoating / galvanising

STEPSAVER

Efficient & versatile personnel carrier



Photos may be shown with optional equipment.



Taylor-Dunn's Stepsaver provides personnel transportation for executives, supervisors, security, maintenance, mail carriers, and other workers whose jobs keep them on the go.

Stepsaver's versatile design allows you to convert the vehicle from personnel carrier to burden carrier in a matter of seconds. These vehicles can carry up to two people or a 272 kg load to the job site.

Standard features include a horn, modularised control system, tiller-loop steering, on-board charger, and an all-welded steel unitised body and frame. Additional standard features on the SS-536 include head light, taillight, brake light and flip-down passenger seat.

Features

- All-welded unitised steel body
- On-board charger
- Modularised control system
- Customisable to fit your application



STEPSAVER PERSONNEL CARRIER

Performance

	SS-536	SS-546
LOAD CAPACITY	272 kg	272 kg
TOW CAPACITY	907 kg*	907 kg*
MAX SPEED (UNLOADED)	14 km/h	14.5 km/h
TURNING RADIUS	190 cm	206 cm

*Based on Standard Configuration: Actual towing capacity is dependent on application, vehicle configuration, ballast weight, and operating environment.

Dimensions

	SS-536	SS-546
OVERALL LENGTH	220 cm	226 cm
OVERALL WIDTH	76 cm	76 cm
HEIGHT (with cab)	POA	POA
DECK HEIGHT	61 cm	61.4 cm
WHEEL BASE	136 cm	137.8 cm
DECK SIZE	76 x 48 cm	76 x 50 cm

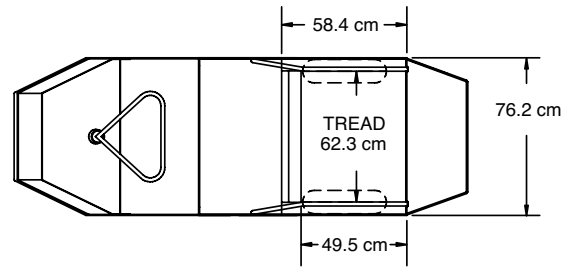
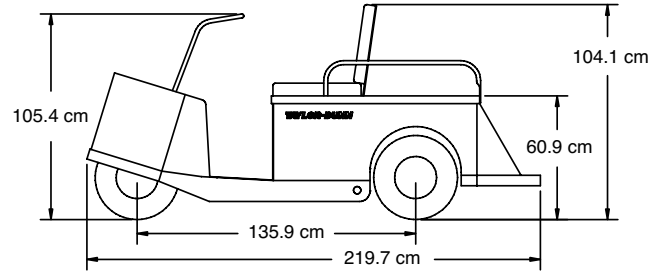

Power supply / Drive train

MOTOR	DC Series Wound 4.5 hp, 24 V Intermitant (1.5 HP @ 60 Min. Rating)
SYSTEM VOLTAGE	24V DC
TRANSMISSION	12:1 Reduction
BATTERIES	Four, 6V, 217 Amp-Hour, Lead Acid
CHARGER	25 Amp, 24V Built In Automatic Charger W/Interlock
CONTROLLER	Solid State Speed Controller 275 amp 24 Volt
WIRING	Modular Harness Design, Weather Protected Connectors

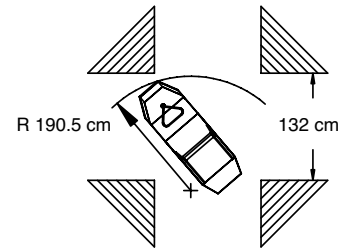

Chassis

FRAME	All Steel Unitized Body, Heavy Duty 16 Gauge Diamond Plate Steel, Standard Front Bumper and Geared Steering
STEERING	Automotive Steering Wheel, Geared Steering
DRIVE AXLE	546: Direct Drive, Oil Bath
SUSPENSION	546: Articulated Front Axle, Coil Springs, Rear
BRAKES	546: Two Wheel Mechanical Rear Drum, Foot Operated Parking Brake
TYRES	4.80 x 8 Load Range B
WIRING	Modular Harness Design, Weather Protected Connectors

General

UNIT WEIGHT	546: 376 Kg
SEATS	546: Foam Padded Cushion and backrest; Flip Down Seat for Passenger
INSTRUMENTATION	Battery Discharge Indicator, Forward/Reverse Selector, Key Switch, Seat Switch
LIGHT ACCESSORIES	546: Headlight, Taillight, Stop Light
CONFORMANCE	Type E OSHA Requirements 1910.178, ANSI B56.8 Requirements

Options

Charger

- Portable 25 amp charger
- Built in 110V/220V 50 hz

Accessories

- Strobe light, amber - on pole
- Reverse alarm
- Hour meter

Deck

- Diamond plate deck
- Clipboard holder

Tyres

- Soft Solid Tyres

Battery

- 244 amp hr battery

Frame

- Smooth skin

Colour

- White or special paint color
- Undercoating

TAKE **ADVANTAGE** OF US WHEREVER YOU ARE

Our commitment to customer satisfaction extends nationwide, thanks to one of the finest branch networks in Australia.

With major Toyota Material Handling outlets for Taylor Dunn electric vehicles, along with forklift sales and rentals located throughout every state of Australia, we've got all your material handling requirements covered.



Other benefits of dealing with Toyota Material Handling include:

- World's Number One Forklift Brand* - Toyota
- Australia's biggest range of materials handling equipment
- Leading product, safety and environmental initiatives
- 100% Toyota owned branches
- Australia's largest rental fleet with over 35,000 units
- Forklift rentals from 1 day to 5 years with flexible finance options available
- 500+ service support staff & 300+ service vans



1800 425 438
toyotamaterialhandling.com.au



**TOYOTA FORKLIFT
ADVANTAGE**

SOLUTIONS FOR EVERY PALLET®

Toyota Material Handling Australia 8 Secombe Place, Moorebank NSW 2170

*dhf Intralogistik Magazine 2024

Toyota Material Handling Australia (TMHA) has used its best endeavours to ensure brochure information is correct when published. All images are used for illustration purposes only and actual colour of products may differ from images displayed. TMHA, to the extent permissible at law, is not liable to any person for loss or damage arising from reliance upon information contained in this brochure. Distributed nationally by Toyota Material Handling Australia Pty Limited ABN 38 104 644 635. 8 Secombe Place Moorebank NSW 2170. Printed April 2026.